

	LED3011	3.0mm ROUND RED LEDS
--	---------	----------------------

Absolute maximum ratings (Ta=25°C)

Reverse Voltage-----	5V
Forward Current-----	20mA
Peak Forward Current-----	150mA
Operating Temperature-----	-25~+85°C
Storage Temperature-----	-25~+85°C
Lead Soldering Temp (1.6mm From Body)--260°C For 3Sec	

Electrical optical characteristics (Ta=25°C)

TYP	Max(mcd)		Forward Voltage IF=20mA(V)		Reverse Current VR=5V(μA)		VIEWING ANGLE
	Min	Typ	Min	Typ	Max	Typ	2θ1/2(DEG)
LED3011	700	1000	1.9	2.1	<1	10	20

TYPE NO	Chip		Lens Color	Peak Wave Length λp(nm)	Spectra Half-Width Δλ(n m)
	Material	Emitting Color			
LED3011	GaASP	RED	WATER CLEAR	620-630	10

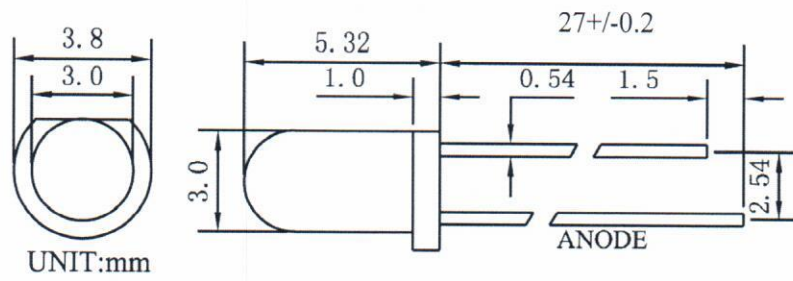

1. All dimensions are in millimeters(inches).
2. Protruded resin under flange is 1.5mm Max.