

	LED3010	3.0mm ROUND WHITE LEDS
--	---------	------------------------

Absolute maximum ratings (Ta=25°C)

Reverse Voltage-----	5V
Forward Current-----	18mA
Peak Forward Current-----	150mA
Operating Temperature-----	-25~+85°C
Storage Temperature-----	-25~+85°C
Lead Soldering Temp (1.6mm From Body)--	260°C For 3Sec

Electrical optical characteristics (Ta=25°C)

TYP	Max(mcd)		Forward Voltage IF=18mA(V)		Reverse Current VR=5V(μA)		VIEWING ANGLE
	Min	Typ	Min	Typ	Max	Typ	2θ1/2(DEG)
LED3010	2000	4000	3.2	3.4	<1	5	30

TYPE NO	Chip		Lens Color	Peak Wave Length λp(nm)	Spectra Half-Width Δλ(n m)
	Material	Emitting Color			
LED3010	GaASP	WHITE	WATER CLEAR		

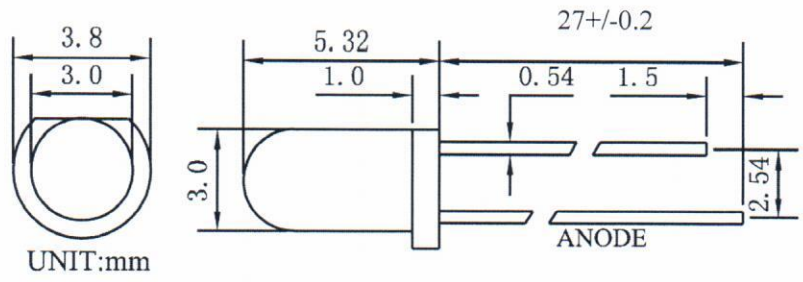

1. All dimensions are in millimeters(inches).
2. Protruded resin under flange is 1.5mm Max.